

20180054960

99

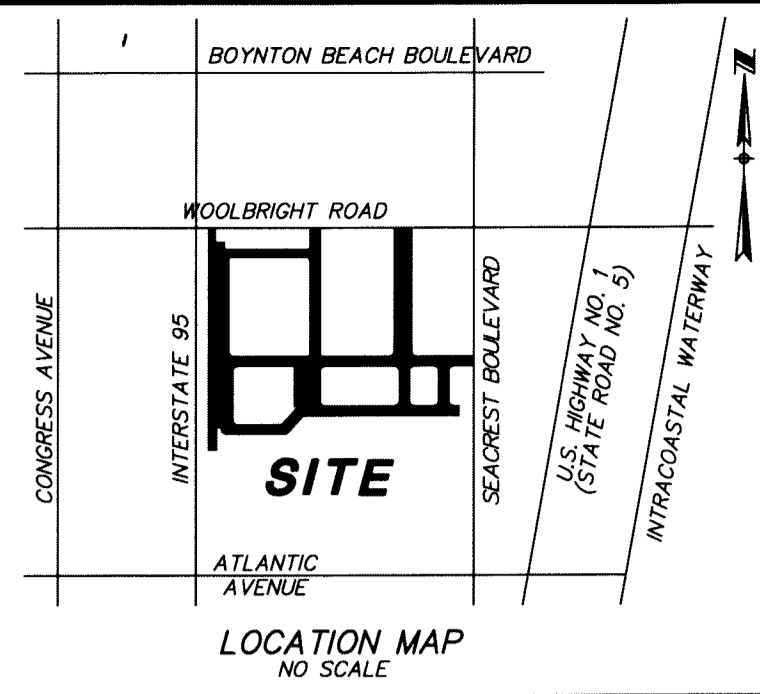

BOYNTON BEACH MEMORIAL PARK PLAT 3

BEING A REPLAT OF A PORTION OF LOT 5, SECTION 33, TOWNSHIP 45 SOUTH, RANGE 43 EAST (P.B. 1, PG. 4); A PORTION OF MUNICIPAL CEMETERY (P.B. 21, PG. 84); A PORTION OF BOYNTON BEACH MEMORIAL PARK (P.B. 27, PG. 186); A PORTION OF BOYNTON BEACH MEMORIAL PARK ADDITION NO. 1 (P.B. 30, PG.'S 154-155) AND A PORTION OF BOYNTON BEACH MEMORIAL PARK ADDITION NO. 2 (P.B. 114, PG. 9) ALL BEING IN SECTION 33, TOWNSHIP 45 SOUTH, RANGE 43 EAST, CITY OF BOYNTON BEACH, PALM BEACH COUNTY, FLORIDA.

SHEET 1 OF 3
MAY 2017

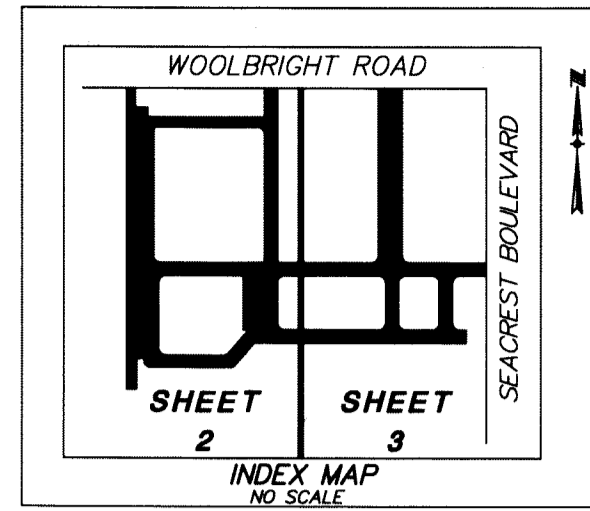

COUNTY OF PALM BEACH
STATE OF FLORIDA
THIS PLAT WAS FILED FOR RECORD AT 12:41 PM
THIS 12 DAY OF February
20 18, AND DULY RECORDED IN PLAT BOOK NO.
185 ON PAGE 99-101
SHARON BOCK, CLERK OF DISTRICT COURT
BY *Walter S. Holden, D.C.*

DEDICATION AND RESERVATION:

STATE OF FLORIDA:

COUNTY OF PALM BEACH:

KNOW ALL MEN THESE PRESENTS THAT THE CITY OF BOYNTON BEACH, INC., A NOT FOR PROFIT CORPORATION OWNERS OF THE LAND SHOWN HEREON BEING A REPLAT OF A PORTION OF LOT 5, SECTION 33, TOWNSHIP 45 SOUTH, RANGE 43 EAST (P.B. 1, PG. 4); A PORTION OF MUNICIPAL CEMETERY (P.B. 21, PG. 84); A PORTION OF BOYNTON BEACH MEMORIAL PARK (P.B. 27, PG. 186); A PORTION OF BOYNTON BEACH MEMORIAL PARK ADDITION NO. 1 (P.B. 30, PG.'S 154-155) AND A PORTION OF BOYNTON BEACH MEMORIAL PARK ADDITION NO. 2 (P.B. 114, PG. 9) ALL BEING IN SECTION 33, TOWNSHIP 45 SOUTH, RANGE 43 EAST, CITY OF BOYNTON BEACH, PALM BEACH COUNTY, FLORIDA. BEING SHOWN HEREON AS BOYNTON BEACH MEMORIAL PARK PLAT 3 AND MORE PARTICULARLY DESCRIBED AS FOLLOWS:

COMMENCING AT THE SOUTHEAST CORNER OF THE PLAT OF BOYNTON BEACH MEMORIAL PARK, ACCORDING TO THE PLAT THEREOF AS RECORDED IN PLAT BOOK 27, PAGE 186, PUBLIC RECORDS OF PALM BEACH COUNTY, FLORIDA; THENCE N.89°59'02"W, ALONG THE SOUTH LINE OF SAID PLAT, A DISTANCE OF 11.83 FEET TO THE POINT OF BEGINNING; THENCE CONTINUE N.89°59'02"W, ALONG SAID SOUTH LINE, A DISTANCE OF 594.45 FEET; THENCE S.44° 59'58"W, A DISTANCE OF 76.62 FEET TO A POINT ON A CURVE CONCAVE NORTHWESTERLY HAVING A CENTRAL ANGLE OF 45°04'35" AND A RADIUS OF 65.00 FEET; THENCE SOUTHWESTERLY AND WESTERLY, ALONG THE ARC OF SAID CURVE, A DISTANCE OF 51.14 FEET; THENCE N.89°55'27"W, A DISTANCE OF 230.08 FEET TO A POINT ON A CURVE CONCAVE NORTHEASTERLY HAVING A CENTRAL ANGLE OF 90°00'00" AND A RADIUS OF 27.00 FEET; THENCE NORTHWESTERLY, ALONG THE ARC OF SAID CURVE, A DISTANCE OF 42.41 FEET; THENCE N.0°04'33"E, A DISTANCE OF 18.00 FEET; THENCE N.89°55'27"W, A DISTANCE OF 40.00 FEET; THENCE S.0°04'33"W, A DISTANCE OF 122.08 FEET TO A POINT ON THE SOUTH LINE OF BOYNTON BEACH MEMORIAL PARK ADDITION NO. 1, ACCORDING TO THE PLAT THEREOF AS RECORDED IN PLAT BOOK 30, PAGES 154 AND 155, PUBLIC RECORDS OF PALM BEACH COUNTY, FLORIDA; THENCE N.89°59'02"W, ALONG SAID SOUTH LINE AND THE WESTERLY PROJECTION OF SAID SOUTH LINE, A DISTANCE OF 29.00 FEET; THENCE N.0° 04'33"E, A DISTANCE OF 613.11 FEET TO A POINT ON THE SOUTH RIGHT OF WAY LINE OF WOOLBRIGHT ROAD AS SHOWN ON ROAD PLAT BOOK 4, PAGE 86, PUBLIC RECORDS OF PALM BEACH COUNTY, FLORIDA; THENCE S.89°56'25"E, ALONG SAID SOUTH RIGHT OF WAY LINE, A DISTANCE OF 20.00 FEET; THENCE S.0°04'33"W, A DISTANCE OF 26.00 FEET; THENCE S.89°56'25"E, A DISTANCE OF 64.00 FEET; THENCE S.0°04'33"W, A DISTANCE OF 6.00 FEET; THENCE S.89°55'27"E, A DISTANCE OF 386.00 FEET; THENCE N.0° 04'33"E, A DISTANCE OF 32.00 FEET TO A POINT ON THE SOUTH RIGHT OF WAY LINE OF SAID WOOLBRIGHT ROAD; THENCE S.89°56'25"E, ALONG SAID SOUTH RIGHT OF WAY LINE, A DISTANCE OF 15.80 FEET; THENCE S.0°07'11"W, A DISTANCE OF 294.88 FEET; THENCE S.89°52'49"E, A DISTANCE OF 304.13 FEET TO A POINT ON A NON TANGENT CURVE CONCAVE TO THE NORTHWEST HAVING A CENTRAL ANGLE OF 66°43'49" AND A RADIUS OF 54.00 FEET; THENCE NORTHEASTERLY, ALONG THE ARC OF SAID CURVE WHOSE CHORD BEARS N.45°07'11"E, A DISTANCE OF 62.89 FEET; THENCE N.0°07'11"E, A DISTANCE OF 253.15 FEET TO A POINT ON THE SOUTH RIGHT OF WAY LINE OF SAID WOOLBRIGHT ROAD; THENCE S.89°56'25"E, ALONG SAID SOUTH RIGHT OF WAY LINE, A DISTANCE OF 16.00 FEET; THENCE S.0°07'11"W, A DISTANCE OF 252.66 FEET TO A POINT ON A CURVE CONCAVE NORTHEASTERLY HAVING A CENTRAL ANGLE OF 90°00'00" AND A RADIUS OF 38.50 FEET; THENCE SOUTHEASTERLY, ALONG THE ARC OF SAID CURVE, A DISTANCE OF 60.48 FEET; THENCE S.89°52'49"E, A DISTANCE OF 156.60 FEET TO A POINT ON THE WEST RIGHT OF WAY LINE OF SEACREST BOULEVARD AND A POINT ON A NON TANGENT CURVE CONCAVE EASTERLY HAVING A CENTRAL ANGLE OF 0°27'22" AND A RADIUS OF 3773.89 FEET; THENCE SOUTHERLY ALONG THE ARC OF SAID CURVE WHOSE CHORD BEARS S.4° 35'50"W, A DISTANCE OF 30.09 FEET; THENCE N.89°52'49"W, A DISTANCE OF 35.16 FEET TO A POINT ON A CURVE CONCAVE SOUTHWESTERLY HAVING A CENTRAL ANGLE OF 90° 00'00" AND A RADIUS OF 11.50 FEET; THENCE SOUTHWESTERLY, ALONG THE ARC OF SAID CURVE, A DISTANCE OF 18.06 FEET; THENCE S.0°07'11"W, A DISTANCE OF 105.50 FEET TO A POINT ON A CURVE CONCAVE NORTHEASTERLY HAVING A CENTRAL ANGLE OF 90°00'00" AND A RADIUS OF 11.50 FEET; THENCE SOUTHEASTERLY, ALONG THE ARC OF SAID CURVE, A DISTANCE OF 18.06 FEET; THENCE S.89°52'49"E, A DISTANCE OF 15.50 FEET; THENCE S.0° 07'11"E, A DISTANCE OF 12.24 FEET TO THE POINT OF BEGINNING.

LESS AND EXCEPT THE FOLLOWING PARCELS:

ALL OF BLOCKS N, O, R, S AND THE AREAS LABELED WALKWAY AROUND SAID BLOCKS, BOYNTON BEACH MEMORIAL PARK ADDITION NO. 1, ACCORDING TO THE PLAT THEREOF AS RECORDED IN PLAT BOOK 30, PAGES 154 AND 154, PUBLIC RECORDS OF PALM BEACH COUNTY, FLORIDA.

AND

ALL OF BLOCKS I, J, K, L AND M; ALL OF DRIVEWAYS 2, 4 AND 7 LYING SOUTH OF THE EASTERLY AND WESTERLY PROJECTIONS OF THE NORTH LINE OF BLOCK M AND NORTH OF THE EASTERLY AND WESTERLY PROJECTIONS OF THE SOUTH LINE OF BLOCK M; ALL OF DRIVEWAY 10 LYING SOUTH OF THE WESTERLY PROJECTION OF THE NORTH LINE OF BLOCK I AND NORTH OF THE WESTERLY PROJECTION OF THE SOUTH LINE OF BLOCK I, ALL BEING IN THE PLAT OF BOYNTON BEACH MEMORIAL PARK, ACCORDING TO THE PLAT THEREOF AS RECORDED IN PLAT BOOK 27, PAGE 186, PUBLIC RECORDS OF PALM BEACH COUNTY, FLORIDA

AND

BLOCKS 2, 3 AND 4, BOYNTON BEACH MEMORIAL PARK PLAT 2, ACCORDING TO THE PLAT THEREOF AS RECORDED IN PLAT BOOK 108, PAGE 38, PUBLIC RECORDS OF PALM BEACH COUNTY, FLORIDA.

OVERALL PARCEL CONTAINING 110,277 SQUARE FEET OR 2.5316 ACRES MORE OR LESS.

HAS CAUSED THE SAME TO BE SURVEYED AND PLATTED AS SHOWN HEREON AND DOES HEREBY DEDICATE AS FOLLOWS:

TRACTS "A", "B", "C" AND "D" ARE HEREBY RESERVED AS WALKWAYS FOR THE PERPETUAL USE OF THE PUBLIC FOR PEDESTRIAN AND OTHER PROPER PURPOSES.

TRACT "E" AS SHOWN HEREON IS HEREBY DEDICATED TO THE CITY OF BOYNTON BEACH, FLORIDA, FOR THE PERPETUAL USE OF THE PUBLIC FOR STREET PURPOSES AND IS SUBJECT TO A UTILITY EASEMENT OVER THE ENTIRE TRACT FOR THE CONSTRUCTION AND MAINTENANCE OF UTILITY FACILITIES, INCLUDING TELEVISION SYSTEMS. THE INSTALLATION OF CABLE TELEVISION SYSTEMS SHALL NOT INTERFERE WITH THE CONSTRUCTION AND MAINTENANCE OF OTHER UTILITIES. THE CITY OF BOYNTON BEACH SHALL HAVE FULL AUTHORITY AND DISCRETION OF APPROVAL OF ANY PRIVATE UTILITY WISHING TO USE SAID EASEMENT.

THE WATER MAIN EASEMENT IS HEREBY DEDICATED TO THE CITY OF BOYNTON BEACH FOR THE CONSTRUCTION AND MAINTENANCE OF WATER MAINS AND OTHER SUPPORTING APPURTENANCES.

THE UTILITY EASEMENT AS SHOWN ARE HEREBY DEDICATED IN PERPETUITY FOR THE CONSTRUCTION AND MAINTENANCE OF UTILITY FACILITIES, INCLUDING TELEVISION SYSTEMS. THE INSTALLATION OF CABLE TELEVISION SYSTEMS SHALL NOT INTERFERE WITH THE CONSTRUCTION AND MAINTENANCE OF OTHER UTILITIES. THE CITY OF BOYNTON BEACH SHALL HAVE FULL AUTHORITY AND DISCRETION OF APPROVAL OF ANY PRIVATE UTILITY WISHING TO USE SAID EASEMENT.

IN WITNESS WHEREOF, THE CITY OF BOYNTON BEACH, INC., A NOT FOR PROFIT CORPORATION HAS CAUSED THESE PRESENTS TO BE SIGNED BY ITS MAYOR, AND ATTESTED BY ITS CITY CLERK AND ITS SEAL TO AFFIXED HERETO THIS 6 DAY OF February, 2018

WITNESS: *Shirley Elms*
WITNESS: *Shirley Elms*

BY: *Steven B. Grant*
STEVEN B. GRANT,
MAYOR

WITNESS: *Catherine Cherry*
WITNESS: *Catherine Cherry*

ATTEST: *Judith Pyle*
JUDITH PYLE,
CITY CLERK

ACKNOWLEDGEMENT

STATE OF FLORIDA
COUNTY OF PALM BEACH

BEFORE ME PERSONALLY APPEARED STEVEN B. GRANT AND JUDITH PYLE TO ME WELL KNOWN, AND KNOWN TO ME TO BE THE INDIVIDUALS DESCRIBED IN AND WHO EXECUTED THE FOREGOING INSTRUMENT AS MAYOR AND CITY CLERK OF THE CITY OF BOYNTON BEACH, FLORIDA, AND SEVERALLY ACKNOWLEDGED TO AND BEFORE ME THAT THEY EXECUTED SAID INSTRUMENT AS SUCH OFFICERS OF THE CITY OF BOYNTON BEACH, FLORIDA.

WITNESS MY HAND AND SEAL THIS 6 DAY OF February, 2018
MY COMMISSION EXPIRES: March 25, 2019
BY: *Jammye S. Stangione*
NOTARY PUBLIC
STATE OF FLORIDA

TITLE CERTIFICATION:

STATE OF FLORIDA
COUNTY OF PALM BEACH
I, JAMES A. CHEROF, A DULY LICENSE ATTORNEY IN THE STATE OF FLORIDA, CERTIFY THAT I HAVE EXAMINED THE TITLE TO THE HEREON DESCRIBED PROPERTY; THAT I FIND THE TITLE TO THE PROPERTY IS VESTED TO THE CITY OF BOYNTON BEACH, A MUNICIPAL CORPORATION; THAT THE PROPERTY IS EXEMPT FROM ALL TAXES; AND THAT THERE ARE NO ENCUMBRANCES OF RECORD THAT WOULD PROHIBIT THE CREATION OF THE SUBDIVISION DEPICTED BY THIS PLAT.

DATE: 2/6/18
BY: *James A. Cherof*
NAME: JAMES A. CHEROF, ESQUIRE
FLORIDA BAR NO. 291846
STATE OF FLORIDA

CITY OF BOYNTON BEACH APPROVAL

STATE OF FLORIDA:

COUNTY OF PALM BEACH:

THIS PLAT IS HEREBY APPROVED FOR RECORD PURSUANT TO THE ORDINANCES OF THE CITY OF BOYNTON BEACH, FLORIDA, AND IN ACCORDANCE WITH CHAPTER 5, LAND DEVELOPMENT REGULATIONS, THIS _____ DAY OF _____ 2017, AND HAS BEEN REVIEWED BY A PROFESSIONAL SURVEYOR AND MAPPER UNDER EMPLOYMENT WITH THE CITY OF BOYNTON BEACH, FLORIDA, IN ACCORDANCE WITH SECTION 177.08(1), FLORIDA STATUTES.

BY: *Craig S. Pusey*
CRAIG S. PUSEY, P.E., STATE OF FLORIDA, LS#5019
REVIEWING SURVEYOR

BOYNTON BEACH MEMORIAL PARK PLAT 3, IS HEREBY APPROVED FOR RECORD THIS 6 DAY OF February, 2018

BY: *Gary R. Dunmyer*
GARY R. DUNMYER, PE
CITY ENGINEER

BY: *Steven B. Grant*
STEVEN B. GRANT
MAYOR

ATTEST (AS TO BOTH): *Judith A. Pyle*
JUDITH PYLE, C.M.C.
CITY CLERK

SURVEYORS CERTIFICATION

THIS IS TO CERTIFY THAT THE PLAT SHOWN HEREON IS A TRUE AND CORRECT REPRESENTATION OF A SURVEY MADE UNDER MY RESPONSIBLE DIRECTION AND SUPERVISION AND THAT THE SURVEY IS ACCURATE TO THE BEST OF MY KNOWLEDGE AND BELIEF AND THAT THE PERMANENT REFERENCE MONUMENTS (P.R.M.'S) HAVE BEEN PLACED AS REQUIRED BY LAW; AND FURTHER THAT THE SURVEY DATA COMPILES WITH ALL THE REQUIREMENTS OF CHAPTER 177 FLORIDA STATUTES AS AMENDED, AND WITH THE APPLICABLE SECTIONS OF 5J-17 FLORIDA ADMINISTRATIVE CODE, AND THE ORDINANCES OF THE CITY OF BOYNTON BEACH, FLORIDA.

DATE: 1/22/18
BY: *Paul D. Engle*
PAUL D. ENGLE
SURVEYOR AND MAPPER #5708
955 N.W. 17TH AVENUE, SUITE K-1
DELRAY BEACH, FLORIDA 33445
CERTIFICATE OF AUTHORIZATION #LB 353

NOTES:

ALL BEARINGS SHOWN HEREON ARE RELATIVE TO THE SOUTH LINE OF PLAT BOOK 27, PAGE 186, HAVING A BEARING OF N.89°59'02"W. AS SHOWN ON SAID PLAT. (ASSUMED)

NOTICE: THIS PLAT, AS RECORDED IN ITS GRAPHIC FORM, IS THE OFFICIAL DEPICTION OF THE SUBDIVIDED LANDS DESCRIBED HEREIN AND WILL IN NO CIRCUMSTANCES BE SUPPLANTED IN AUTHORITY BY ANY OTHER GRAPHIC OR DIGITAL FORM OF THE PLAT. THERE MAY BE ADDITIONAL RESTRICTIONS THAT ARE NOT RECORDED ON THIS PLAT THAT MAY BE FOUND IN THE PUBLIC RECORDS OF THIS COUNTY.

THE CITY OF BOYNTON BEACH IS HEREBY GRANTED THE RIGHT OF ACCESS FOR EMERGENCY AND UTILITY MAINTENANCE PURPOSES.

THIS INSTRUMENT WAS PREPARED BY PAUL D. ENGLE, IN THE OFFICE OF O'BRIEN, SUITER & O'BRIEN, INC., 955 N.W. 17TH AVENUE, SUITE K-1, DELRAY BEACH, FLORIDA 33445 (561) 276-4501.

PERMANENT REFERENCE MONUMENTS ARE SHOWN THUS: ○

THERE SHALL BE NO TREES OR SHRUBS PLACED ON UTILITY EASEMENTS WHICH ARE PROVIDED FOR WATER AND SEWER USE OR UPON DRAINAGE EASEMENTS, LANDSCAPING OR ANY OTHER UTILITY EASEMENT SHALL BE ALLOWED ONLY AFTER CONSENT OF ALL UTILITY COMPANIES OCCUPYING SAME.

